

Kurzbedienungsanleitung/
Quick operation guide
Rychlý návod na obsluhu

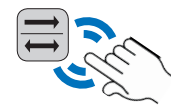

Touch & Slide

Allgemeine Bedienung • General handling • Operazione generale • Opération générale
• Obecná manipulace

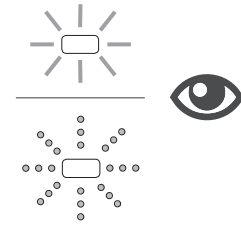
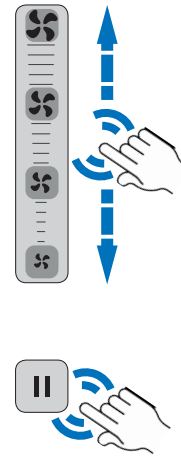
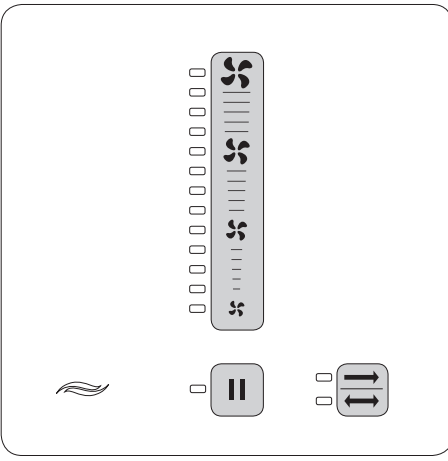

Erstaktivierung • First activation • Attivazione iniziale • Déclenchement initial
• Počáteční aktivace

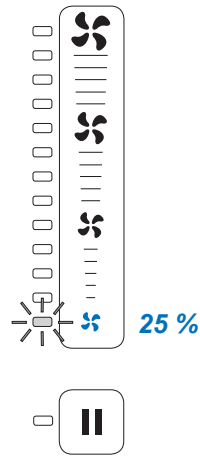
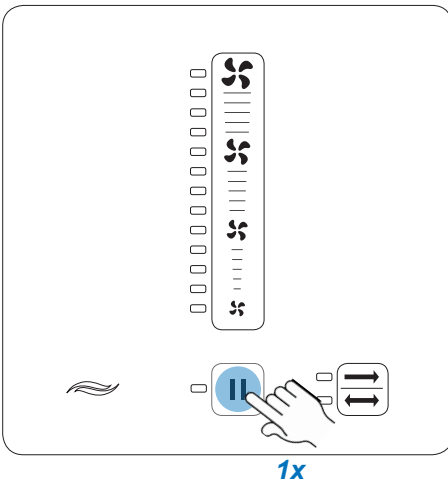

Betriebsart **Wärmerückgewinnung und **Durchlüftung** einstellen** • Setting **heat recovery** and **continuous ventilation** mode • Impostazione delle modalità **Recupero di calore** e **Aerazione unidirezionale**
• Nastavení provozního režimu **zpětný zisk tepla** a **trvalé větrání**

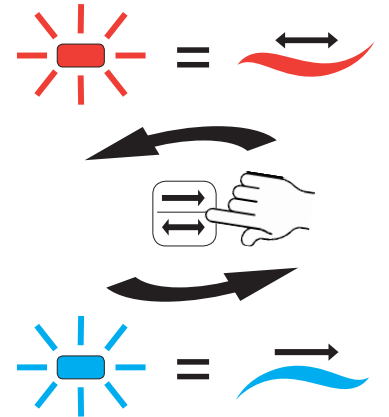
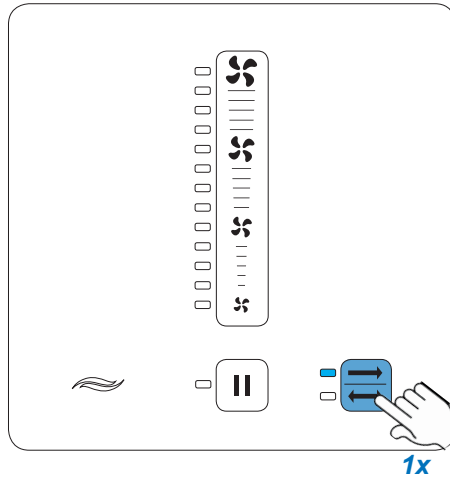
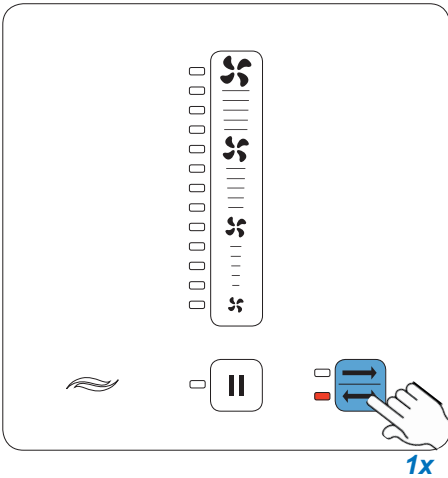

Leistung einstellen • Setting output level • Impostazione dei livelli di potenza •
Réglage de la puissance • Nastavení stupně (intenzity) větrání

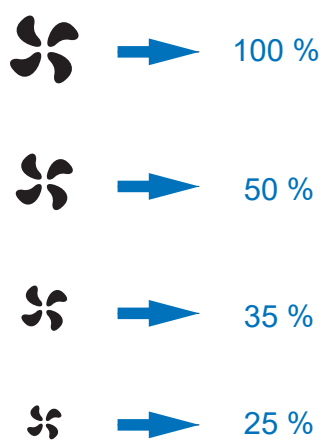
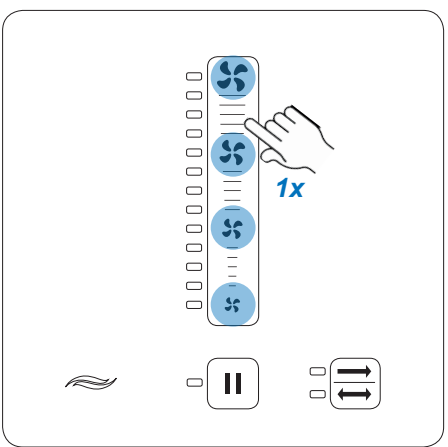

Option:

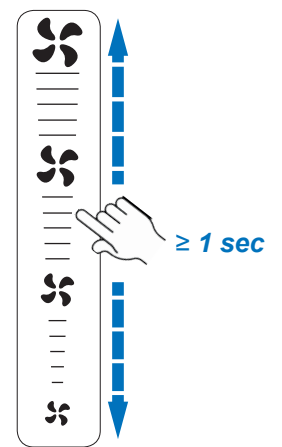

Boost Funktion einstellen • Setting the Boost function • Impostazione della funzione Boost •
Ajuster la fonction Boost • Nastavení krátkodobého zesílení intenzity větrání

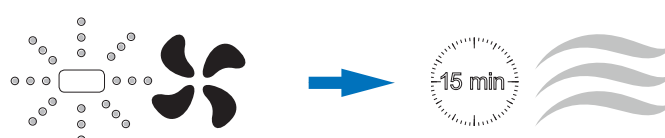
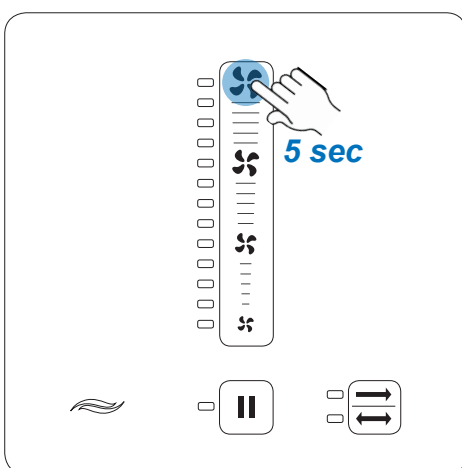

Aktivierung der Pausen Funktion • Activating the pause function • Impostazione della Pausa • Ajuster Pause/Mise hors tension • Aktivace funkce pauza

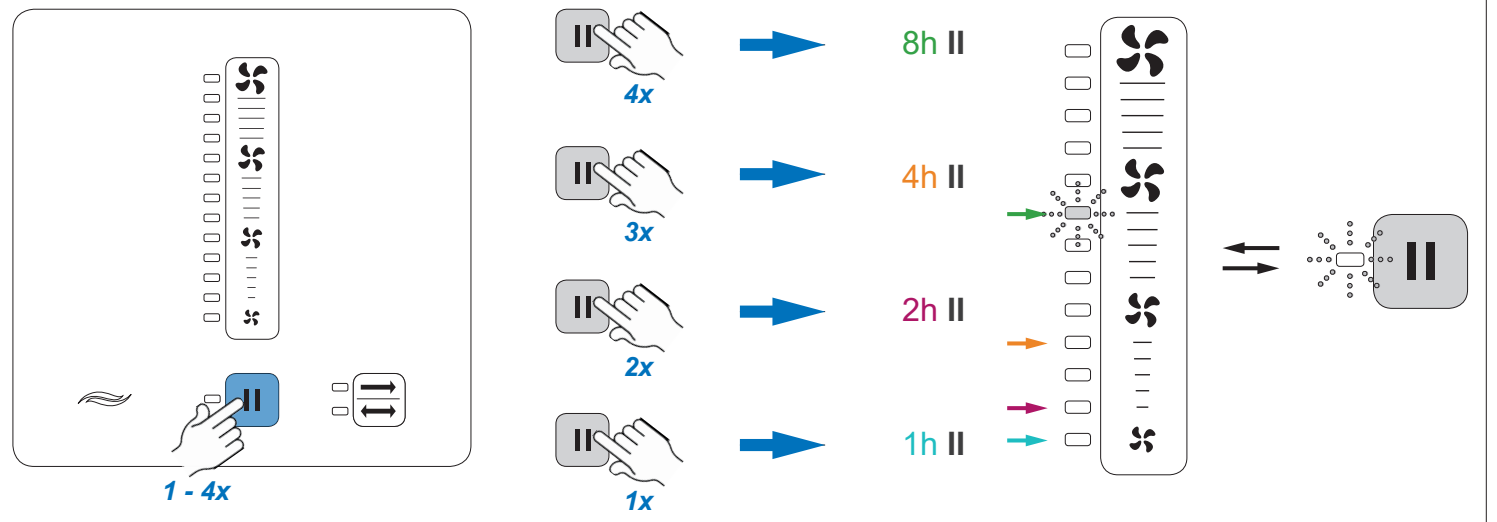

Verbleibende Pausenzeit anzeigen • Display remaining pause time • Visualizzazione del tempo di pausa rimanente • Affichage du temps de pause restant • Zobrazení zbývajícího času pauzy

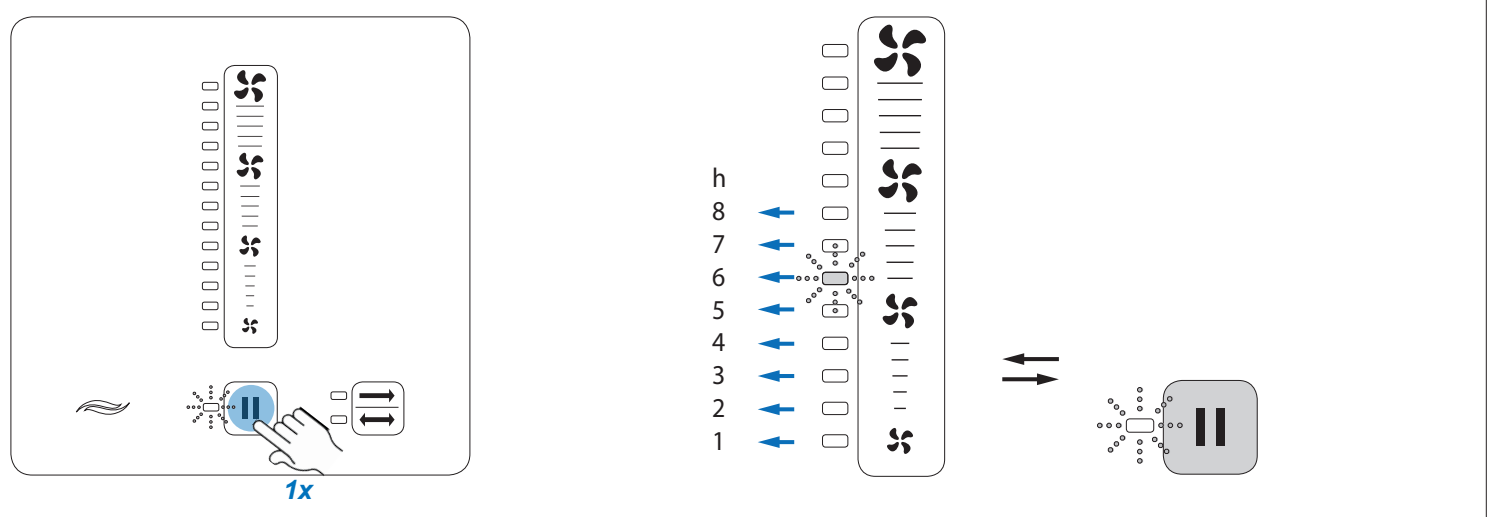

Filterwechsel bestätigen • Confirm filter change • Conferma la sostituzione del filtro • Confirmer le changement du filtre • Potvrzení výměny filtru

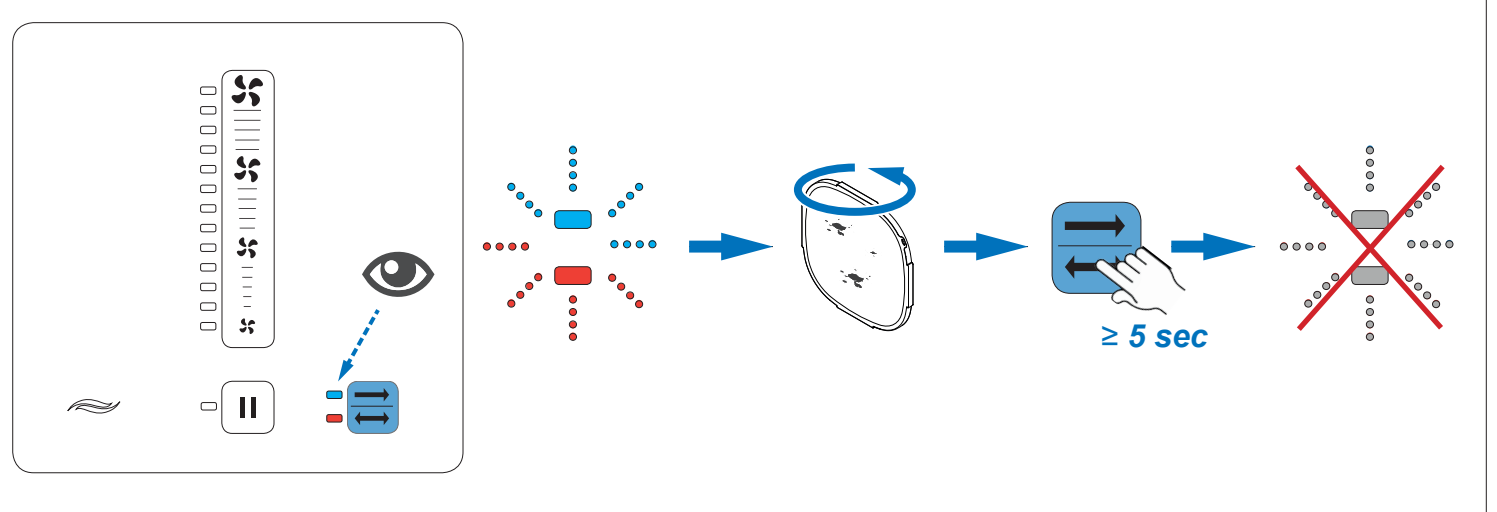

Betriebstage abrufen • Show operating days • Visualizza i giorni di operazione • Afficher les jours d'opération • Zobrazení provozní doby ve dnech

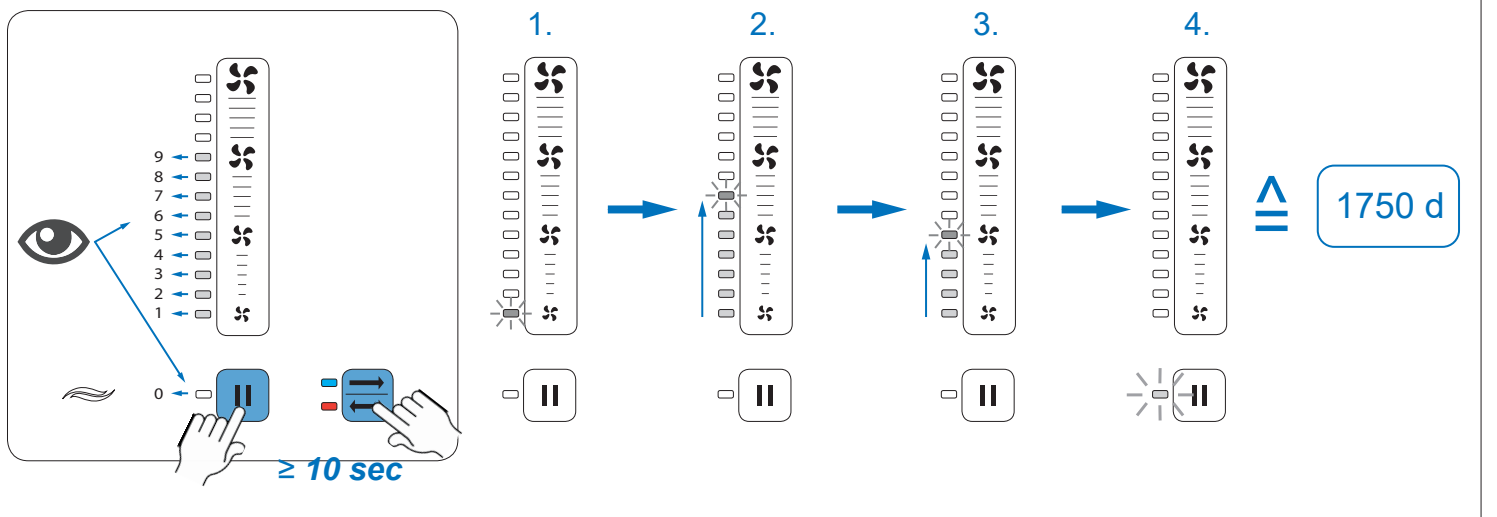

Automatischer Energiesparmodus • Automatic energy saving mode • Modo basso consumo automatico • Économie d'énergie automatique • Automatický režim úspory energie

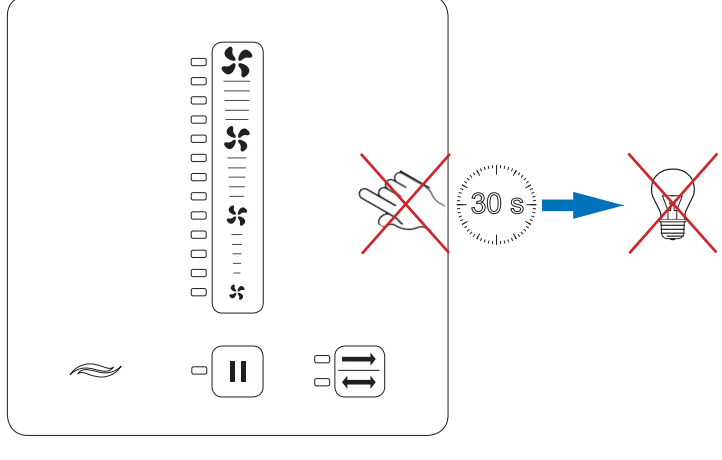

Regler ausschalten (nur Standard-Version) • Switch off controller (standard version only) • Spegnere il regolatore • Eteindre le régulateur

